

**ETA Process Instrumentation**

www.etapii.com  
sales@etapii.com  
tel 978.532.1330

**Martech Controls**

www.martechcontrols.com  
sales@martechcontrols.com  
tel: 315.876.9120

## PO2-1120 Percent Oxygen Sensor

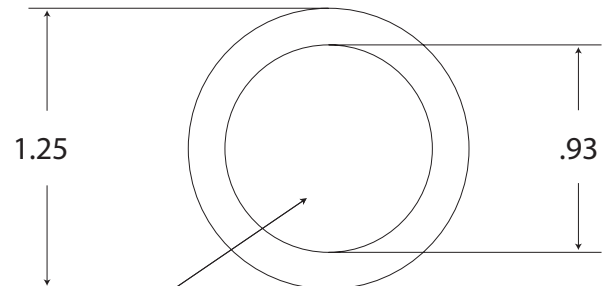

Sensing Surface

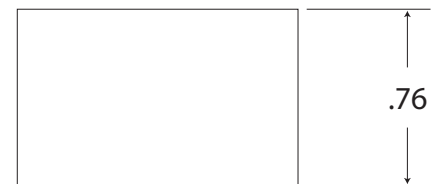

PCB Assembly

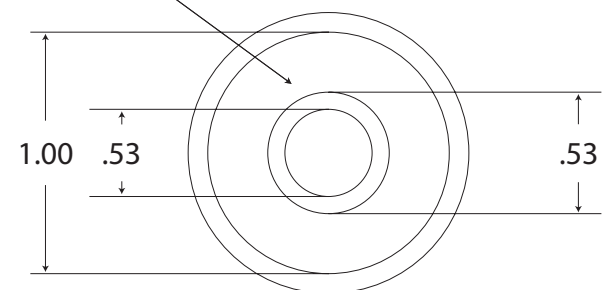

### Specifications:

Sensor Technology	Micro Fuel Cell
Signal Output <sup>1</sup>	28 - 52 uA
Measuring Range	0 - 100 Percent
Response Time T90	13 Seconds
Accuracy Full Scale <sup>2</sup>	± 1% of Signal
Repeatability F.S.	± 0.5%
Temp Coefficient	2.54 % / ° C
Operating Temp	0 to 50 ° C
Storage Temp	0 to 45 ° C
Recommended Flow	0.5 - 2 SCFH
Humidity	0 - 100% RH (Non-Condensing)
Expected Life <sup>3</sup>	120 Months
Storage	9 Months
Warranty <sup>4</sup>	12 Months
PCB Connection	Center Foil Negative Outer Foil Positive

### Direct Replacement Guide

Analytical Industries: GPR-11-120; GPR-11-120OP

1. Signal output is measured in air at 25 ° C, sea level.
2. Accuracy full scale is calculated with constant pressure and temperature & proper calibration (90% O<sub>2</sub> value on full scale range). Drastic temperature change can result in a maximum error of ± 10%.
3. Expected life is calculated when O<sub>2</sub> is 20.9% @ 25 ° C, sea level.
4. Southland Sensing warrants these sensors for the period noted above to be free from defects in materials and workmanship. Southland Sensing will not be held liable for sensors damaged due to customer neglect.