

PO2-154 Percent Oxygen Sensor

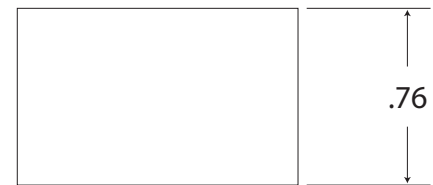

PCB Assembly

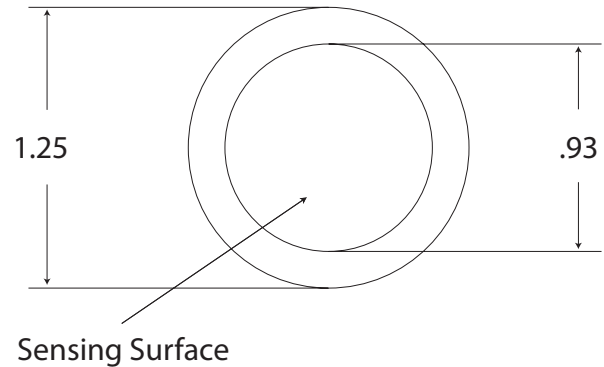
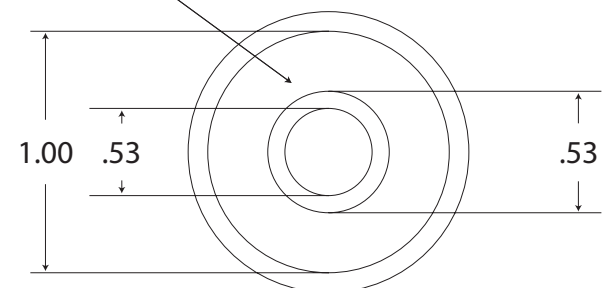

Specifications:

Sensor Technology	Micro Fuel Cell
Signal Output ¹	160 - 240 uA
Measuring Range	0 - 100 Percent
Response Time T90	7 Seconds
Accuracy Full Scale ²	± 1% of Signal
Repeatability F.S.	± 0.5%
Temp Coefficient	2.54 % / °C
Operating Temp	0 to 50 °C
Storage Temp	0 to 45 °C
Recommended Flow	0.5 - 2 SCFH
Humidity	0 - 100% RH (Non-Condensing)
Expected Life ³	25 Months
Storage	6 Months
Warranty ⁴	12 Months
PCB Connection	Center Foil Negative Outer Foil Positive

1. Signal output is measured in air at 25 °C, sea level.
2. Accuracy full scale is calculated with constant pressure and temperature & proper calibration (90% O₂ value on full scale range). Drastic temperature change can result in a maximum error of ± 10%.
3. Expected life is calculated when O₂ is 20.9% @ 25 °C, sea level.
4. Southland Sensing warrants these sensors for the period noted above to be free from defects in materials and workmanship. Southland Sensing will not be held liable for sensors damaged due to customer neglect.

Direct Replacement Guide

Analytical Industries: PSR-11-54
 Teledyne: C-3

New England - ETA Process Instrumentation

119 Foster Street, Bldg #6
 Peabody, MA 01960
 Tel: (978) 532-1330
 www.etapii.com
 sales@etapii.com

Upstate NY - Martech Controls

2000 Teall Avenue
 Syracuse, NY 13026
 Tel: (315) 876-9120
 www.martechcontrols.com
 sales@martechcontrols.com